

## Group 12 Exhaust System

**GENERAL:** This group contains information on the automotive engine exhaust system from the engine exhaust manifold to the tailpipe.

**SPECIFICS:** As applicable

- ...Exhaust Muffler
- ...Exhaust Pipes
- ...Exhaust Shields
- ...Tailpipe



FMC Corporation  
Motor Coach Division  
333 Brokaw Road Box 664 Santa Clara California 95052

# REPAIR PARTS LIST

GROUP 12 Exhaust System  
MODEL 2900R

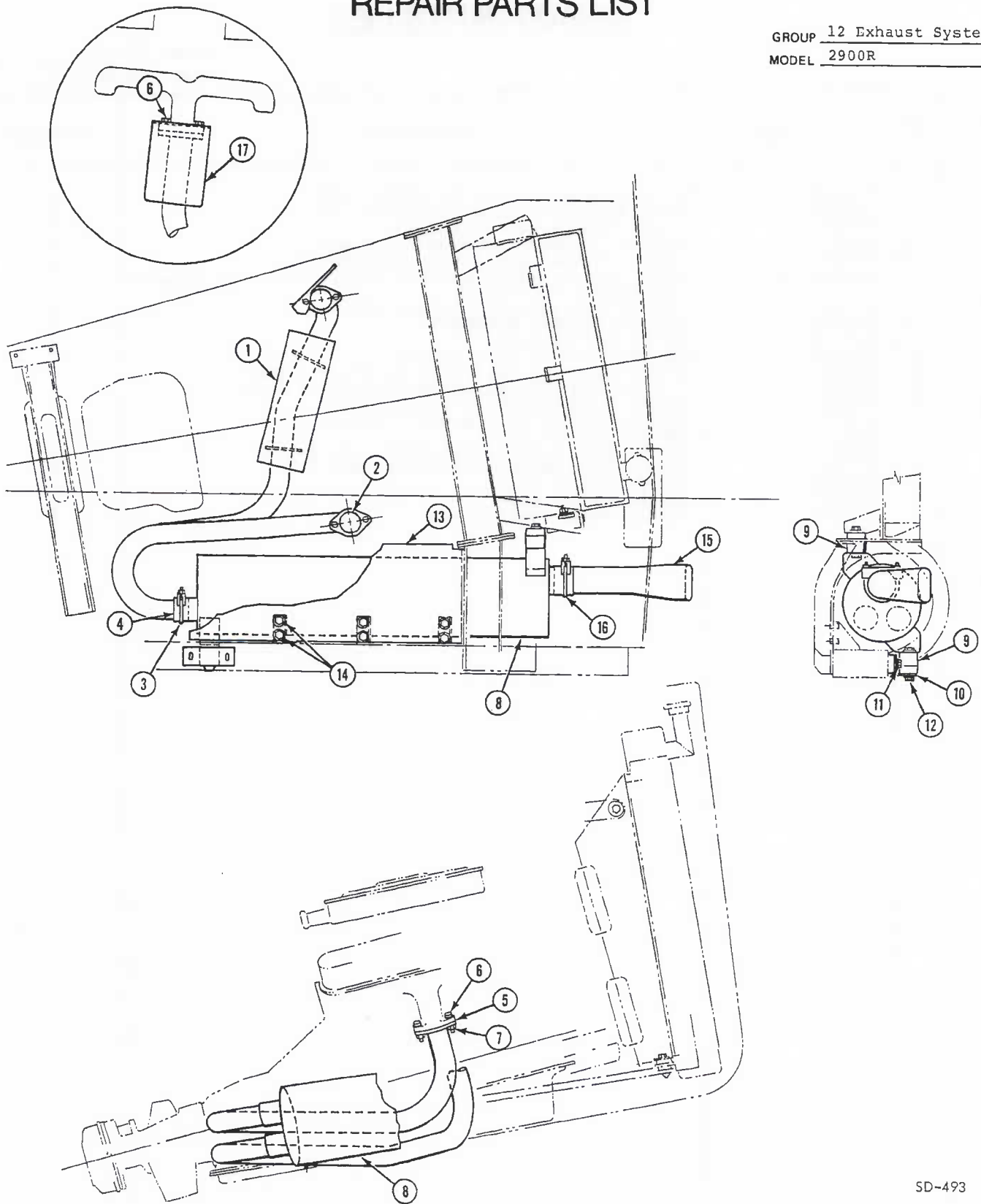

Figure 12-1. Exhaust System

SD-493

# REPAIR PARTS LIST

GROUP 12  
MODEL 2900R

FIG NO.	ITEM NO.	PART NUMBER	ITEM DESCRIPTION	QTY PER UNIT
12-1	1	5101287	PIPE, Exhaust manifold to muffler - RH	1
	2	5101288	PIPE, Exhaust manifold to muffler - LH	1
12-1	3	M25004	CLAMP, Exhaust pipe attaching	2
	4	M25006	BUSHING, Exhaust pipe attaching clamp	2
	5	M22016	GASKET, Exhaust pipe flange (CCMI-2465391)	2
12-1	6	5100800-22	BOLT, Pipe to exhaust manifold (7/16-14 x 1 3/4; Grade 8) (Supersedes 5100800-20)	4
	7	M17138	NUT, Exhaust pipe bolt (7/16 x 14)	4
	8	5101224	MUFFLER ASSEMBLY W/BRACKETS	1
	9	5101192	MOUNT, Muffler rubber	2
	10	5101225	BRACKET, Muffler mount forward	1
	11	M18087	SCREW, Muffler mount bracket (3/8 x 16 x 3/4)	2
	11	M17004	WASHER, Muffler mount bracket screw (3/8 flat)	4
	12	M18032	SCREW, Muffler mount (1/2 x 13 x 5/8)	4
	12	M17023	WASHER, Muffler mount screw (1/2 flat)	4
	13	5100887	SHIELD, Muffler heat	1
	14	M18058	SCREW, Muffler heat shield (5/16 x 24 x 3/4)	6
	14	M17005	WASHER, Heat shield screw (5/16 flat)	6
	15	5101226	SPOUT, Muffler rear	1
	16	M25005	CLAMP, Muffler spout	1
	17	5101801	SHIELD, Power steering hose	1