

Group 16 Transmission

GENERAL: This group contains information on the purchased transmission that is not covered in the other groups. It covers all transmission parts from the converter to the output shaft, and all installation parts.

SPECIFICS: As applicable

- ...Converter
- ...Drum-Parking Brake
- ...Gears
- ...Output Shaft
- ...Shift Mechanism
- ...Shift Valves
- ...Transmission Housing



FMC Corporation
Motor Coach Division
333 Brokaw Road Box 664 Santa Clara California 95052

REPAIR PARTS LIST

16 Transmission
 GROUP Assembly
 MODEL 2900R

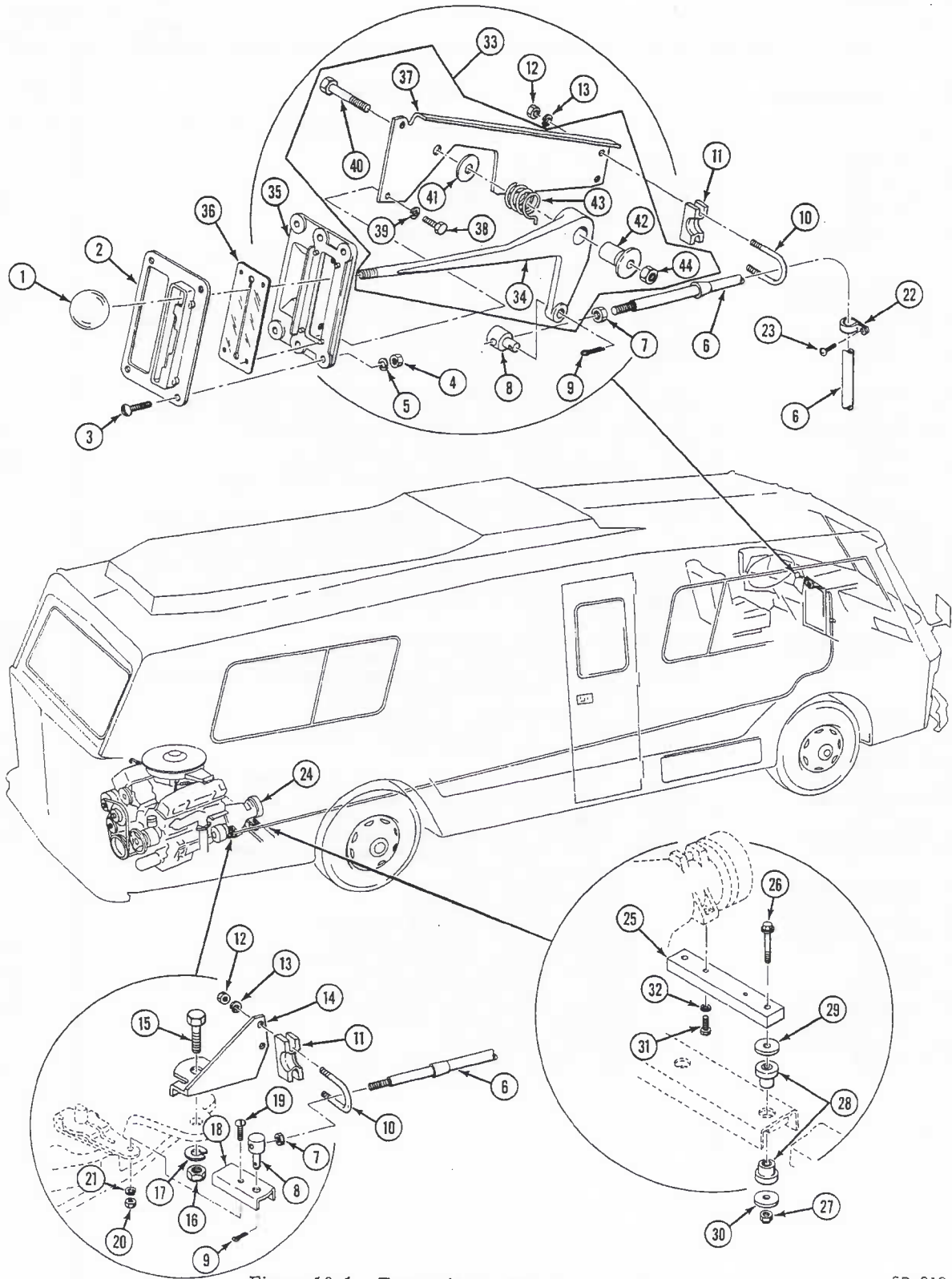

Figure 16-1. Transmission Mounting and Linkage

SD-219

FMC FMC Corporation
 Motor Coach Division
 333 Brokaw Road Box 664 Santa Clara California 95052

ISSUED 5/73
 REVISED C4, 9/76

REPAIR PARTS LIST

GROUP 16
MODEL 2900F

FIG NO.	ITEM NO.	PART NUMBER	ITEM DESCRIPTION	QTY PER UNIT
16-1	1	5101380	KNOB, Range lever	1
	2	5101182	PLATE, Range lever detent	1
	3	M14245	BOLT, Detent plate (6-32 x 3/4)	4
	4	M17063	NUT, Detent plate bolt (6-32)	4
	5	5101182-R001	WASHER, Detent plate bolt split(6)	4
	6	5107921-01	CABLE ASSY, Transmission to gearshift control (SUP 5100326-01)	1
16-1	7	5100326-R001	NUT, Transmission cable assy (1/4-28)	2
	8	5100328-R001	PIVOT, Transmission lever extension to cable assy (1/4-28)	2
16-1	9	M25080	COTTER PIN, Transmission lever extension pivot (3/32 x 1/2)	2
	10	5100328-R003	U-BOLT, Transmission cable assy to bracket (1/4-28)	2
	11	5106329	SHIM, Transmission cable assy U-bolt (SUP 5100328-R004).	2
	12	MS51922-5	NUT, Transmission cable U-bolt (1/4-28)self locking	4
	13	M17024	WASHER, Transmission cable assy U-bolt (split, 1/4)	4
	14	5100328-R005	BRACKET, Mounts cable assy to transmission	1
	15	M18002	BOLT, Transmission bracket (1/2-13 x 1)	1
	16	M17056	NUT, Transmission bracket bolt (1/2-13)	1
	17	M17006	WASHER, Transmission bracket bolt (split, 1/2)	1
	18	5100328-R002	EXTENSION, Transmission lever	1
	19	M18056	BOLT, Transmission lever extension (No. 10-24 x 1/2)	1
16-1	20	M17052	NUT, Transmission lever extension bolt (No. 10-24)	1
	21	M17047	WASHER, Transmission lever extension bolt, split (No. 10)	1
	21	M17033	WASHER, Transmission lever extension bolt, flat (No. 10)	1
	22	5100327	CLAMP, Transmission cable assy support (1/2 ID)	6
16-1	23	M14036	SCREW, Transmission cable assy clamp (self tapping) (No. 10 x 1/2)	6
	24	5100011-R025	TRANSMISSION ASSY (CCMI-3640825)	1
	24	5100011-R152	DIPSTICK, Transmission oil (CCMI-2466302)	1
			NOTE: Component parts of transmission are available through Chrysler Dodge Centers	
	25	5101086	SUPPORT, Transmission to frame	1
	26	M18071	BOLT, Support to frame (5/8-18 x 4-3/4)	2
	27	M17019	NUT, Support bolt (5/8 - 18)	2
	28	5100456-01	MOUNT, Transmission	4
	29	5100570-05	WASHER, Transmission mount (flat 0.656 ID)	2
	30	5100570-01	WASHER, Transmission mounth (flat 0.640 ID)	4
16-1	31	M18042	SCREW, Support to transmission (7/16 - 14 x 1-3/4)	2
	32	5100453-R001	WASHER, Support screw (CCMI-603050)	2
	33	5100325-01	CONTROL ASSY, Trans. range selector w/o knob (on instrument panel)	1
	34	5100325-R003	LEVER, Range selector	1
	35	5100325-R008	HOUSING, Range control	1
	36	5100325-R009	SHIELD, Range control housing	1
	37	5100325-R010	HANGAR, Range selector cable	1
	38	M18061	SCREW, Hangar to housing (1/4 - 20 x 1/2)	2
	39	M17024	WASHER, Hangar screw (1/4)	2
	40	5100325-R007	BOLT, Lever pivot (5/16 - 18 x 1-1/2)	1
16-1	41	5100325-R006	WASHER, Pivot bolt plastic	1
	42	5100325-R005	BUSHING, Pivot bolt	1
	43	5100325-R004	SPRING, Pivot bolt	1
	44	M17039	NUT, Pivot bolt (5/16 - 18)	1